

Road Service Quick Reference Guide
2016 Lincoln MKX



Quality and Education Services
AAA Automotive
1000 AAA Drive
Heathrow, FL 32746

December 12, 2015

Index

Towing, Loading and Transporting	2
Curb Weight	2
Car Carrier Loading	3
Neutral Tow mode	4
Brake-Shift Interlock Override	5
Jacking and Tire Service	6
Fuel Service	8
Jump-Start Procedures	9
Electronic Key	10
Parking Brake and Hood Release	12

Important Notice:

This publication should not be used while driving. The procedures in this publication should only be used by qualified and trained personnel.

This Road Service Quick Reference Guide was developed to highlight some common procedures when servicing or towing a Lincoln vehicle. It is not all inclusive. For complete information: the applicable vehicles owner's manual, Ford Wrecker Towing Manual and the AAA Towing and Service Manual should be used in conjunction with this guide.

The procedures recommended and described in this guide are effective methods of performing light service and towing operations. Some of these procedures require the use of auxiliary equipment specially designed for the purpose. The auxiliary equipment should be used when and as recommended and whenever the trained operator deems it appropriate. It is important to read the various WARNINGS, CAUTIONS and NOTES in this manual in order to minimize the risk of personal injury to service personnel and or customers and to avoid procedures which may damage the vehicle or render it unsafe. It is also important to understand that these warnings, cautions and notes are not exhaustive. Neither AAA nor the auto and towing equipment manufacturers could possibly know, evaluate and advise the reader of all conceivable methods of towing or evaluate individual situations. Accordingly, anyone who uses a towing procedure must be thoroughly convinced that neither personal safety nor vehicle safety will be jeopardized by the selected procedure.

AAA is not responsible for changes made by the manufacturers to the vehicles or their recommendations. Important changes in procedures will be furnished to all manual users on the internet at AAA.biz/auto.

TOWING, LOADING AND TRANSPORTING:

Base Curb Weight

MKX -FWD: 4,168 lbs.

MKX -AWD: 4,387 lbs.

Correct towing equipment for specific models:

The use of car carrier equipment is the preferred method of towing all Lincoln vehicles. A secondary, alternative wheel lift with dollies procedure may be used when a car carrier is inaccessible.

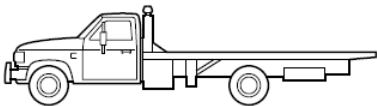

Car Carrier is the Recommended Towing Procedure for: All Lincoln vehicles

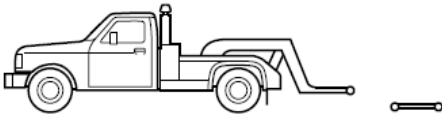

Secondary, Alternative Procedure: Wheel lift with Dollies: AWD, FWD, Front Wheel Lift and Rear Wheel Lift

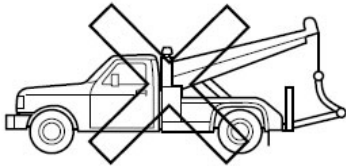

Ford Motor Company has not approved a slingbelt towing procedure. Vehicle damage may occur if towed incorrectly, or by any other means.

CAR CARRIER LOADING:



Front T-Slot



Nylon Bridal with Short Nylon Strap Extension

Use the front two reinforced T-slots to load the vehicle onto a car carrier. The use of a nylon bridle with a secondary nylon strap will assist in avoiding damage to the under panel splash shields.

Before loading, ensure that the transmission is in “Neutral”.

Securing the Vehicle for Transport

Note: Wheel Straps should be used to secure the vehicle for transport. A secondary method is securing by using the reinforced T-hook slots.

When the vehicle is in its loaded position on the flatbed with the bed still in the deployed position, secure the vehicle to prevent it from rolling by chocking the wheels and attaching one wheel strap or tie down to the wheel closest to you, then set the parking brake.

Caution: Do not overly tighten the tie downs or the vehicle may be damaged.

After securing, return the bed to the transporting position, then slacken the winch wire rope slightly to prevent downward pull as bumps are encountered during transport.

Note: Make sure that the ignition switch is in the OFF position, the vehicle is in Park and parking brake is set.

Neutral Tow mode:

Caution: Prior to performing this procedure secure the vehicle and ensure it will not roll. Deploy wheel chocks.

- Release the parking brake.

Enter Neutral Tow mode by doing the following:

1. Put the ignition in accessory mode by pressing the engine START button without pressing the brake pedal.
2. Select Neutral Tow under the Vehicle Settings menu in the information display.
3. Press and hold the OK button to start the neutral tow process.
4. Press the brake pedal and select N on the push-button transmission.
5. Turn the ignition off by pressing the engine START button without pressing the brake pedal.

If the process completes successfully:

- The N on the push-button transmission blinks slowly.
- Neutral Tow Engaged turn ignition off for towing appears in the information display.

Note: If the parking brake is applied, Neutral Tow Remove Park Brake for Towing appears in the information display.

Exit Neutral Tow mode, make sure the ignition is on (engine can be on or off), press the brake pedal and select P.

BRAKE-SHIFT INTERLOCK OVERRIDE:

Use the brake-shift interlock override to move the transmission from the Park position in the event of a malfunction.

Caution: Prior to performing this procedure secure the vehicle and ensure it will not roll. Deploy wheel chocks.

1. Apply the parking brake and turn the ignition off before performing this procedure.



2. Locate the brake-shift interlock access slot. The slot is located in the lower position of the center console storage bin. The access slot does not have a label.

Note: Make sure that you correctly identify the access hole as not to damage the media hub.

3. Using a tool, press and hold the brake shift interlock switch. The shift buttons on the instrument panel will flash when the vehicle is in override mode.
4. With the override switch still held, press the Neutral button (N) to shift from Park.
5. Release the override button.
6. The vehicle will remain in Stay in Neutral mode for wrecker towing purposes or can be shifted to the desired gear and driven (if possible).
7. Release the parking brake.

JACKING AND TIRE SERVICE:



This model may be equipped with an inflator kit. Lincoln requires that these models be towed for a flat tire. **Do not** deploy the inflator kit.

Spare Tire Change Procedure -When Equipped

Note: Chock the tires and set the parking brake to ensure the vehicle will not move.



The spare tire and factory tools are located in the rear cargo area under the package shelf, in the wheel well.



Use the jacking points shown above. Place the jack in its proper location. Observe all standard jacking precautions and ensure that the vehicle is on firm, level ground and that the wheels are chocked. As the jack comes in contact with the vehicle body, ensure that it is contacting the correct location on the vehicle.

Stowing the flat tire:

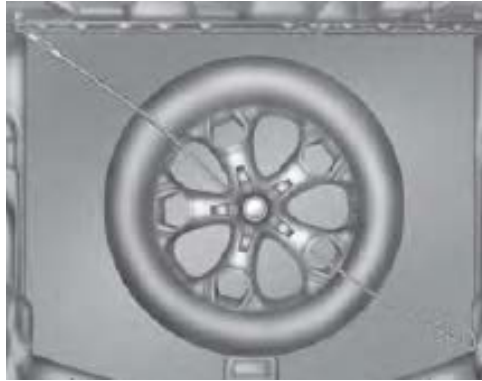

If the road wheel you removed cannot be secured in the wheel well area, use the cargo tie-down located near the seatback to secure the road wheel.

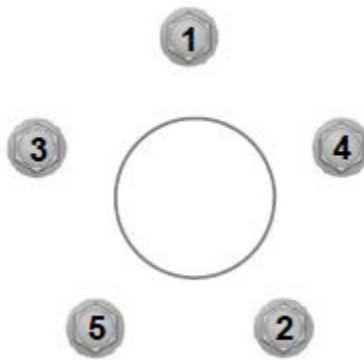

Tighten lugnuts in the pattern shown above

Wheel Lug Nut Torque Specifications

When a wheel is installed, always remove any corrosion, dirt or foreign materials present on the mounting surfaces of the wheel or the surface of the wheel hub, brake drum or brake disc that contacts the wheel. Make sure that any fasteners that attach the rotor to the hub are secured so they do not interfere with the mounting surfaces of the wheel. Installing wheels without correct metal-to-metal contact at the wheel mounting surfaces can cause the wheel nuts to loosen and the wheel to come off while the vehicle is in motion, resulting in loss of control.

Bolt size	lb.ft (Nm)*
M14 x 1.5	162 lb.ft (220 Nm)

*Torque specifications are for nut and bolt threads free of dirt and rust. Retighten the lug nuts to the specified torque as soon as possible and no more than 100 miles (160 kilometers) after changing a flat tire.

WARNING: Failure to follow these precautions could cause the wheel nuts to loosen and the tire to fall off, resulting in death or serious injury.

- Never use oil or grease on the wheel bolts or wheel nuts. Oil and grease may cause the wheel nuts to be excessively tightened, leading to bolt or disc wheel damage. In addition, the oil or grease can cause the wheel nuts to loosen and the wheel may fall off, causing a serious accident. Remove any oil or grease from the wheel bolts or wheel nuts.
- When installing a tire, only use wheel nuts that have been specifically designed for that wheel.
- Check for any cracks or deformations in the bolt screws, nut threads or bolt holes of the wheel.
- Never install a wheel with excessive rust. Light surface rust should be cleaned off of the wheel and mounting surface.
- Never install a tire with excessive tread wear.

FUEL SERVICE:



Locate the portable funnel that comes with the vehicle. The fuel filler funnel is located in the spare wheel storage tray. Carefully insert the funnel into the capless fuel system to add fuel.

Note: Lincoln recommends adding a minimum of 1.3 gal of fuel to restart the engine. If the vehicle is out of fuel and on a steep slope, more fuel may be required.

FUEL SHUTOFF:

In the event of a moderate to severe collision, this vehicle includes a fuel pump shutoff feature that stops the flow of fuel to the engine. Not every impact will cause a shutoff.

Should the vehicle shut off after a collision, you may restart the vehicle. For vehicles equipped with a key system:

1. Switch off the ignition.
2. Switch on the ignition.
3. Repeat steps 1 and 2 to re-enable the fuel pump.

For vehicles equipped with a push button start system:

1. Press the START/STOP button to switch off the ignition.
2. Press the brake pedal and press the START/STOP button to switch on the ignition.
3. Remove your foot from the brake pedal and press the START/STOP button to switch off the ignition.
4. You can either attempt to start the engine by pressing the brake pedal and the START/STOP button, or switch on the ignition only by pressing the START/STOP button without pressing the brake pedal. Both ways re-enable the fuel system.

JUMP-STARTING:

MKX - The battery is located on the driver's side of the engine compartment.



Ground Location-exposed lug on the driver's side strut tower

- Follow all normal jump-starting precautions as outlined in other AAA/CAA publications and those provided by the manufacturer.
- Ensure that all electrical accessories and the ignition switch are turned OFF and the ignition key is removed from the ignition before connecting jumper cables or a jumper box to the discharged vehicle.

ELECTRONIC KEY:



The intelligent access keys operate the power locks and the remote start system. The key must be in the vehicle to activate the push-button start system.

Removable Key Blade: The intelligent access key also contains a removable mechanical key blade that you can use to lock or unlock the driver door.

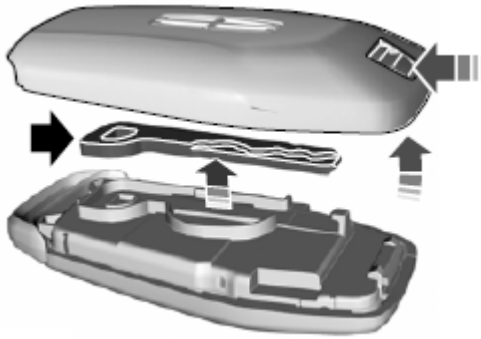

Slide the release on the back of the remote control and pivot the cover off to access the key blade.

If the key is not detected try the following:

1. Open the floor console storage compartment lid.

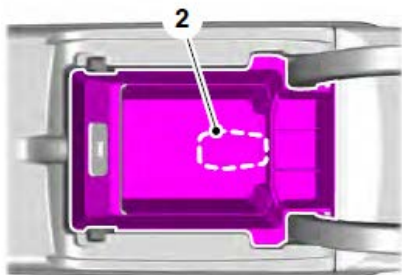

2. With the buttons facing the rear of your vehicle and the key ring up, place the intelligent access key into the backup slot.
3. With the key in this position, press the brake pedal then the push button ignition switch to switch the ignition on and start the vehicle.

Changing Batteries in the Intelligent Access Transmitter

Note: Replacing the battery will not delete the transmitter from the vehicle. The transmitter should operate normally. The remote control uses two coin-type three-volt lithium batteries CR2025 or equivalent.



1. Slide the release on the back of the remote control and pivot the cover off.



2. Insert a coin into the slot and twist to separate the housing.

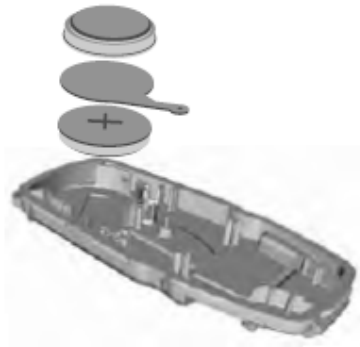

3. Remove the batteries.
4. Install new batteries with the + facing each other.

Note: Make sure to replace the label between the two batteries.

5. Reinstall the housing and cover.

ELECTRONIC PARKING BRAKE:



Pull to apply the parking brake

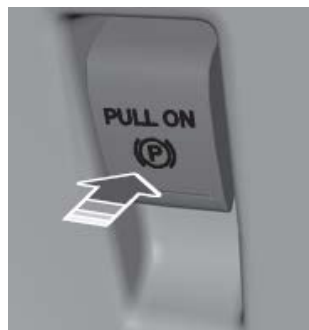

Push to release the parking brake

Release the electric parking brake either manually by pressing the bottom of the switch down or automatically.

HOOD RELEASE:



To open the hood: pull the hood release handle located under the left-hand side of the instrument panel.